

# 2121 QUANTUM

Full body harness with 2 fall-arrest attachment points: 1 front, 1 back.

New conception full body harness whose structure is especially developed in order to increase comfort for movements during working and for suspension after fall as well, reducing thus the dangerous effects of suspension trauma.

Comfort of the new webbing structure is increased also by paddings on leg-loops and back part.

The weight of “Quantum” is reduced to the minimum thanks to the use of few metal components: all the attachment points are made with lightweight double-layer webbing loops.

“Quantum” is equipped with two small loops needed for the application of the suspension trauma straps “HelpStep” ref.2062.

CE EN 361

CONSTRUCTION

ROOFS

PLATFORMS

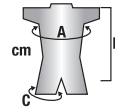

SIZE	A (cm)	C (cm)	D (cm)
1 S-L	80-120	45-65	55-75
2 L-XXL	90-140	55-75	65-85

● = Fall arrest attachment element



- ① Polyester main webbing width 44 mm.
- ② Quick adjustment chest buckles made of carbon steel.
- ③ CE label including serial number
- ④ “A/2” front attachment point for fall-arrest. Made with a doublelayer of webbing.
- ⑤ Sternal plastic buckle
- ⑥ New construction with movable side junctions improves suspension comfort.
- ⑦ Patented “Sicura” quick adjustment buckles
- ⑧ Leg-loops padding. Thickness 6mm. Inside layer made of breathable 3D mesh
- ⑨ Polyamide leg-loops webbings Width 25mm

2121 **QUANTUM**



- ① Back padding. Thickness 3mm. Inside layer made of breathable 3D mesh.
- ② “A” back attachment point for fall-arrest. Made with a double layer of webbing.
- ③ Central webbing for belt support.
- ④ Loops for the installation of “HelpStep” suspension trauma straps ref.2062.
- ⑤ Elastic back webbing.
- ⑥ Leg-loops back webbings. Elastic and adjustable.
- ⑦ Webbing keepers for the size adjustment of leg-loops padding.

INSTALLATION OF “HELPSTEP”  
SUSPENSION STRAPS REF.2062

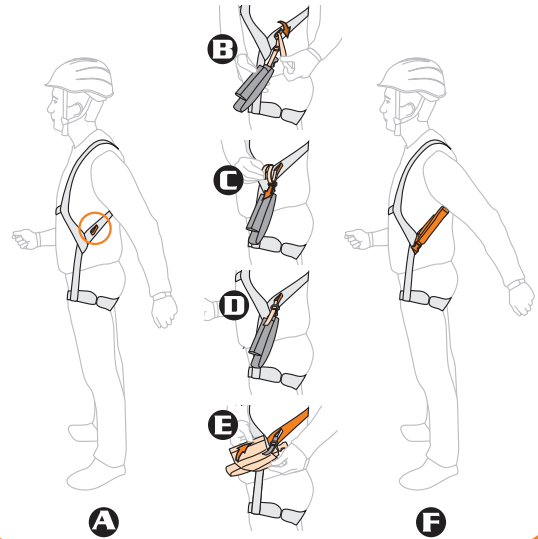

TECHNICAL DRAWINGS

